State Water Resources Control Board

NOTICE OF WORKSHOP ON HOW TO COMPLY WITH WATER MEASUREMENT REGULATIONS

State Water Resources Control Board (State Water Board or Board) staff will hold an in-person workshop in the Clear Lake Watershed on how to comply with the Board's surface water measurement regulations:

Monday, April 24, 2023

11:00 a.m. to 1:00 p.m. PST

Mendocino College, Round Room, 2565 Parallel Dr., Lakeport, CA 95453

FORMAT

The workshop will include presentations from State Water Board staff and opportunities for questions and discussion. Board staff will explain how the water measurement regulations work and provide guidance on how to submit data to the Board. Staff will also briefly discuss the process to register storage ponds.

BACKGROUND

The State Water Board is looking for ways to protect the Clear Lake hitch, a large minnow found only in Clear Lake and its tributaries. Historically, the hitch likely numbered in the millions, but the hitch population has been declining for many years. Each spring, adult hitch migrate up Clear Lake tributaries to spawn before returning to the lake. Without enough water flowing during this time, the hitch cannot successfully spawn or return to the lake.

The Board is taking multiple actions to protect the hitch including collaborating with local Tribes and agricultural groups to help keep water in the creeks and obtain data to better understand the problem and potential solutions. The Board is also focused on ensuring water use in the Clear Lake watershed is legal and compliant with the state's measurement and reporting requirements. The Board relies on accurate diversion measurements and annual reports for water resource planning and to keep diverters informed, particularly in times of drought or when public trust resources, such as the Clear Lake hitch, are threatened.

All surface water diverters must [report their water use](#) to the Board each year. Those who are authorized to divert more than 10 acre-feet per year must comply with the Board's [water measurement regulations](#), which require the installation of measuring

devices and set standards for monitoring and reporting diversions of water (see Title 23 of the California Code of Regulations, sections 931 through 938). Board staff estimate that most surface water diverters in the Clear Lake watershed are out of compliance with at least one of these requirements. The purpose of the workshop is to help surface water diverters in the Clear Lake Watershed comply with these requirements.

PARTICIPATION INFORMATION

To participate in the workshop, please join us at 11:00 AM at Mendocino College, Round Room, 2565 Parallel Dr., Lakeport, CA 95453 ([Map](#), Figure 1). There will be plenty of time to ask questions. Additional workshops can be arranged if enough people are interested.

TARGET AUDIENCE

- Water right holders who
 - can divert more than 10-acre feet per year (riparian, pre-1914 appropriative, and post-1914 appropriative).
 - have more than 10-acre feet of storage capacity in a reservoir.
 - recently received a [Notice of Violation](#) for non-compliance with water measurement regulations.
- “[Qualified Individuals](#)” (defined by the measurement regulation)
- Consultants who manage water rights or diversions
- Diverters interested in small water right projects such as Small Domestic Use, Small Irrigation Use, or Livestock Stockpond registrations.

ADDITIONAL INFORMATION

For information on the Board’s Clear Lake hitch response, please visit the Board’s [Clear Lake Hitch webpage](#). This webpage is updated regularly.

The Board also hosts a [Water Measurement Regulations webpage](#) with details on the regulations, steps to comply, technical resources, and previous presentations and workshops.

CLEAR LAKE HITCH UPDATES

If you would like to receive email updates about the Board’s Clear Lake hitch efforts, please sign up for the email list at the bottom of the [Clear Lake Hitch webpage](#).

QUESTIONS

For assistance with the workshop, please email ClearLakeHitch@waterboards.ca.gov.

For assistance with measurement regulations and reporting, please email DWR-Measurement@waterboards.ca.gov or call (916) 341-5300.

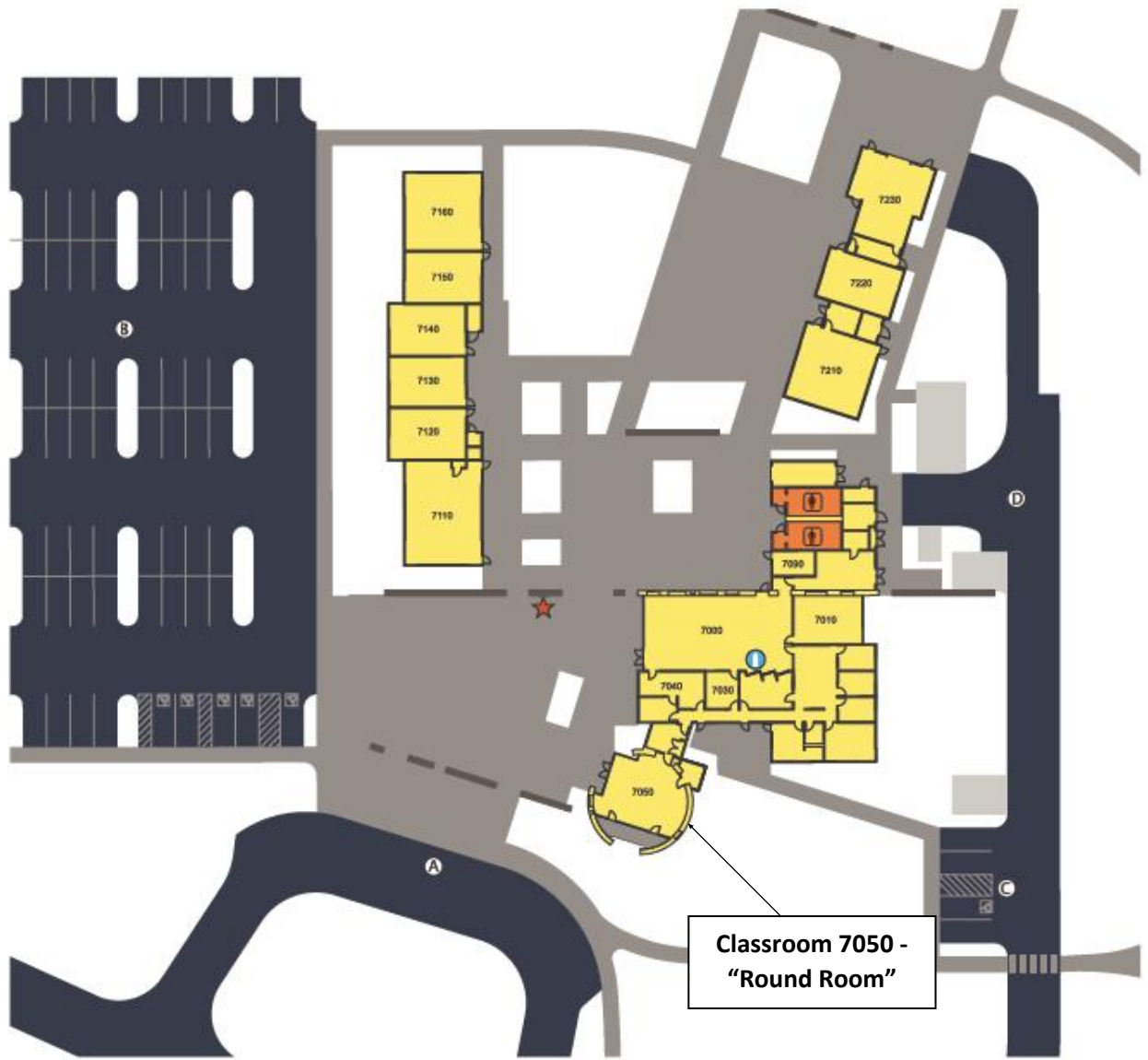

Mendocino College Lake Center
 2565 Parallel Drive, Lakeport, CA 95453



LEGEND

- ★ You are here
- Roads
- Buildings
- Walkways & Plazas
- Restrooms
- Utilities
- ⓘ Information
- Ⓐ Drop Off Zone
- Ⓑ Student Parking
- Ⓒ Staff Parking
- Ⓓ Service & Deliveries

- 7000 Learning Commons
 - 7010 Learning Lab
 - 7030 Group Study Room
 - 7040 Center Operations
 - 7050 Classroom
 - 7090 Vending
-
- 7110 Computer Lab
 - 7120 Classroom
 - 7130 Classroom
 - 7140 Classroom
 - 7150 Classroom
 - 7160 Classroom
-
- 7210 Science Classroom
 - 7220 Classroom
 - 7230 Classroom

Figure 1. Mendocino College Lake Center Map and Room Round Room location.